

Installation Instructions Auto Folding P51A Mirror Module

July 1, 2022

TRAC

ELECTRONICS

Email: info@tracelectronics.com.au

Website: <https://tracelectronics.com.au/>

Model # P51A

Instructions Suitable for the Ford Everest, Raptor and Ranger MK3 onward models

Module Function: Lock doors using key remote, both mirrors fold in, unlock doors using key remote both mirrors fold out or turn ignition on mirrors fold out (this is user selectable). Override button on dash above mirror directional switch operates normally when ignition is on.

Basic knowledge of vehicles electrical system is required to fit this module, if you do not have sufficient skill levels to undertake this installation, it is recommended that installation be carried out by a registered auto electrician.

System includes:

- P51A Mirror Module
- Harness with direct plug & play connectors & pre terminated connectors
- Adhesive pad (hook & loop) to attach module to inside of dash

NOTE: Read full instructions before commencing installation.

First test the existing electric mirror function before starting this installation.

1. Turn on the ignition
2. Press the round auto fold button located on top of the mirror directional buttons. If operating correctly both mirrors will fold in, press the button again they should completely fold out. If they do not function in this way, then this module will not operate correctly. Do not proceed with installation until they operate accordingly.

Trim removal upper: first turn ignition off and remove the key (if applicable)

1: Remove the fuse access cover located under the headlight switch

- Place your hand in the recess and pull directly back

2: Partially remove the fascia that holds the auto mirror direction button there are three retaining clips located on the left-hand side and two locking tabs on the right it is not necessary to completely remove this assembly as there is enough room to remove the mirror connector from the rear.

- Using a trim tool insert between the instrument panel and mirror switch fascia as shown in below images, until the three clips are released. (Refer images on next page)
- There is a locking tab in the centre of the white connector push this down then pull the connector completely out.



Installation Instructions Auto Folding P51A Mirror Module

July 1, 2022

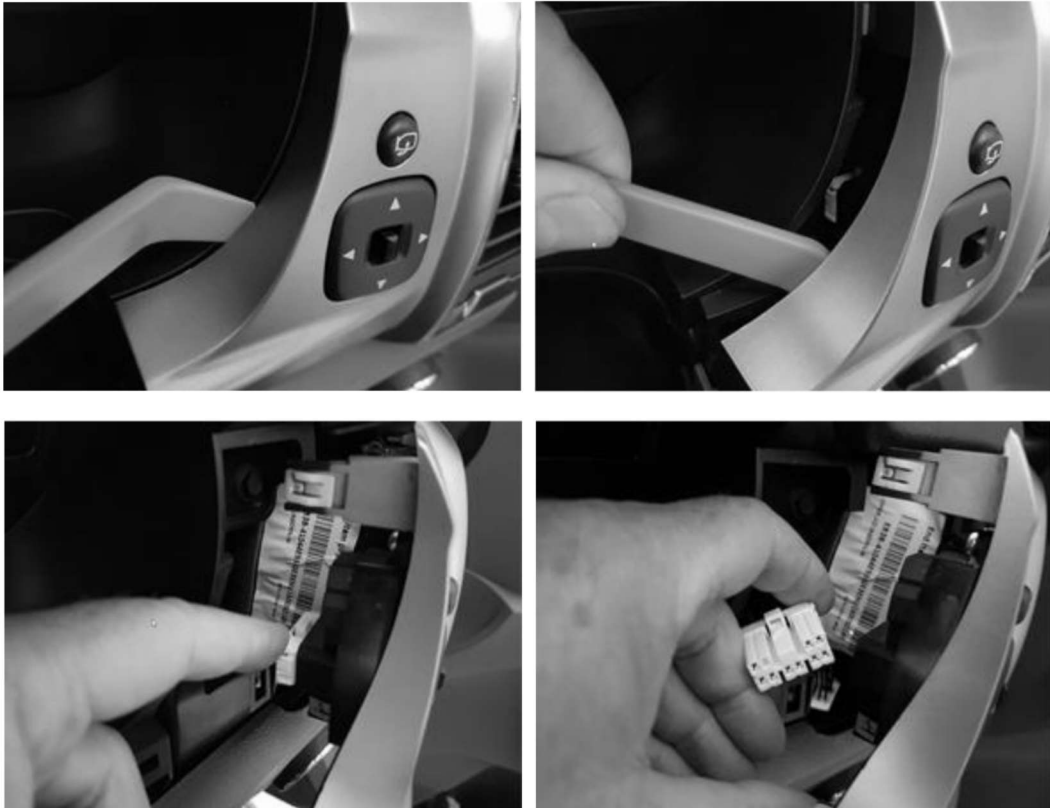

Wiring harness installation:

3: Routing the mirror module wiring harness

- Feed the new mirror module harness from the top in between the dash and partially removed fascia until the two white mating connectors are equal with the mirror switch
- Connect the factory mirror connector to one side of the new harness then connect the corresponding connector into the back of the mirror switch
- Route the sixteen-pin connector and the three loose cables: 12v fuse tap (red) the grey & purple wires are routed to the top left-hand side of the fuse panel (refer following images) and the red wire to the fuse panel
- The mirror module sixteen pin connector should be located on the right-hand side above the fuse box.



Installation Instructions Auto Folding P51A Mirror Module

July 1, 2022

4: Locate the: ③ **ECU connector** located to the top left-hand side of the fuse panel.

Locate the vehicles central locking lock signal wire (grey with brown striped wire) located within this connector pin 35 (ECU connector) located to the top left-hand side of the fuse panel. And the vehicles central locking unlock signal wire pin 32 (brown with green striped wire) located within the same ECU connector.

Note: The wire colours may differ however the pin locations are always the same (below line drawing is of the front face of the connector).

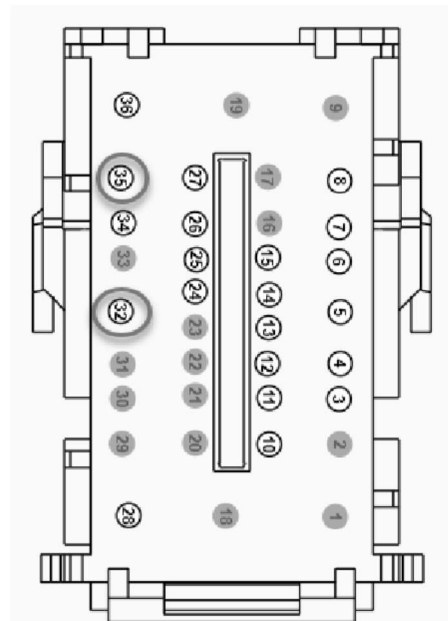

Installation Instructions Auto Folding P51A Mirror Module

July 1, 2022

The module can be configured to extend the side mirrors out in two different ways:

1. Mirrors only extend after the vehicle's ignition has been turned on
2. Mirrors extend every time you unlock the vehicle using the key remote

Option 1: Connect only the grey lock control wire

Option 2: Connect both wires.

Do not remove this connector from the ECU unless the battery has been isolated (negative battery cable removed from the negative battery terminal post).

Using the supplied T connectors clamp over the wires until they click into place using standard pliers. **Ensure the T connector is properly over the appropriate coloured wire.** Connect the purple wire (unlock) and grey wire (lock) – option 2 or just the grey wire (lock) – option 1



12v Power input: Locate a constant power location, it is recommended you use an unallocated fuse location if possible.

Position: 1,2 are generally free.

NOTE: Do not use an existing fuse location that has an existing fuse rating higher than 15 amps.

5: Test:

- Before reassembly test module operation
- Turn on ignition
- First test normal operation of auto fold function (located above mirror switch) this should function normally.
- Remove key from ignition (if applicable) and close all doors
- Using the vehicles key remote press lock, mirrors will fold in
- Insert key in ignition and turn on, mirrors will fold back out (fitment option 1)
- Using the vehicles key remote press unlock, mirrors will fold out (fitment option 2).

If the above does not function correctly check all connections are correctly fitted and **secure!**

- All T connectors are connected correctly and on the correct coloured wires
- The mirror connector(s) are correctly fitted in place
- Fuse is in the correct location (constant power) has not blown (replacement use a 10A Micro2 fuse)

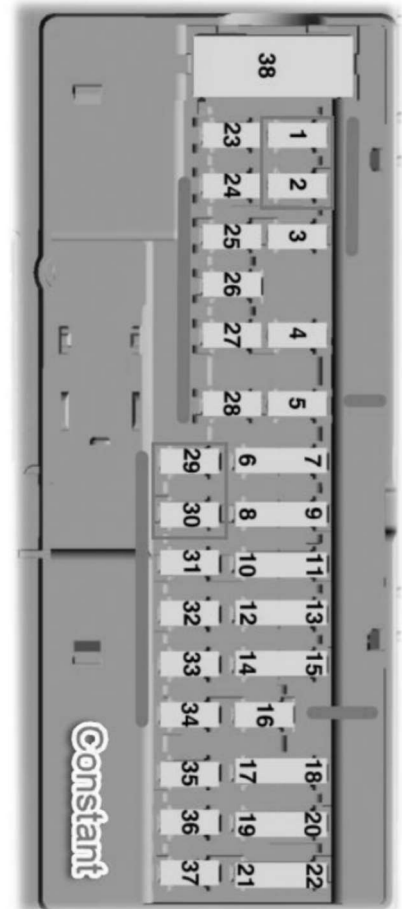

Installation Instructions Auto Folding P51A Mirror Module

July 1, 2022

- The factory auto fold button located on top of the mirror directional buttons is in the off position

6: Affixing the control module in place:

- Using the hook & loop patch supplied affix to the rear of the control module and then locate the unit inside the middle right of the fuse box area on a smooth surface.
- Using the supplied cable ties route and affix the wires and harness so they are neatly secured.

7: Reassembly:

- Align the locking tabs of the mirror switch fascia and push back into place.

NOTE: If the auto function of the driver's window switch is not operating then it will need to be reset.

When power has been disconnected for an extended period of time the auto function on the driver's window will need to be reset.

Perform the following to the driver's side window switch with the ignition on:

Lift and hold the window control switch up until the window is fully closed, keep the window control switch held up for a few additional seconds.

Then press and hold the window control switch down until the window is fully open. Keep the window control switch held down for a few additional seconds.

This will reprogram the auto function on the driver's window switch

